

DIR[®]

Mohega II

6877-2G

INSTRUCTION MANUAL

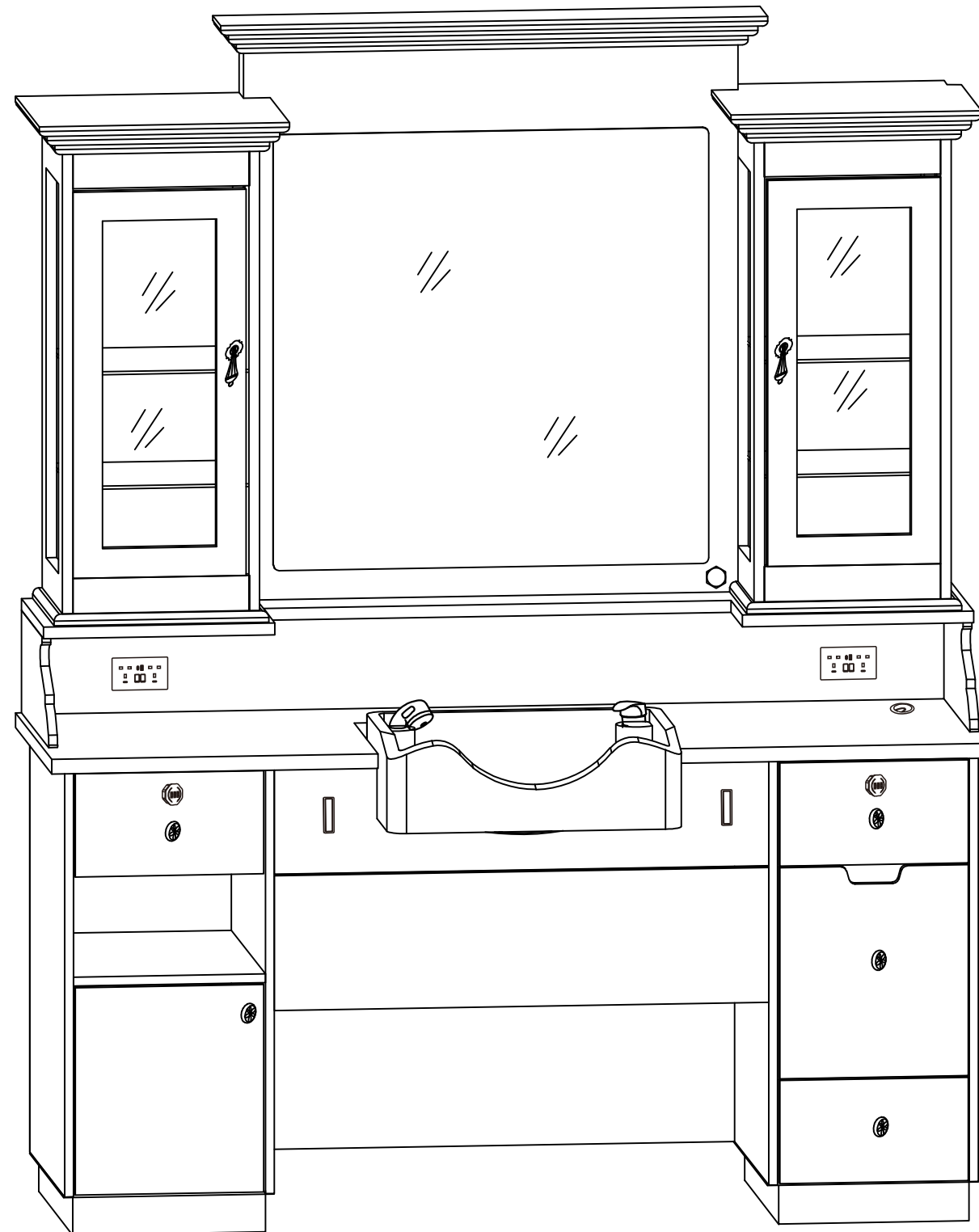

List of Parts & Tools

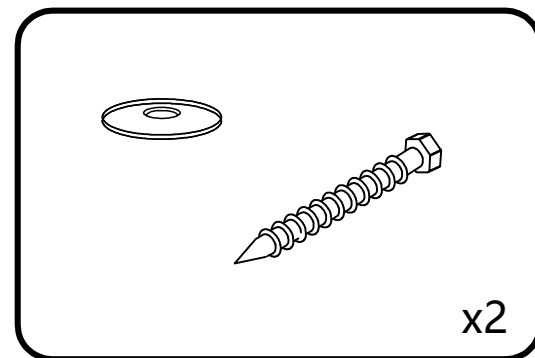

x2

101001

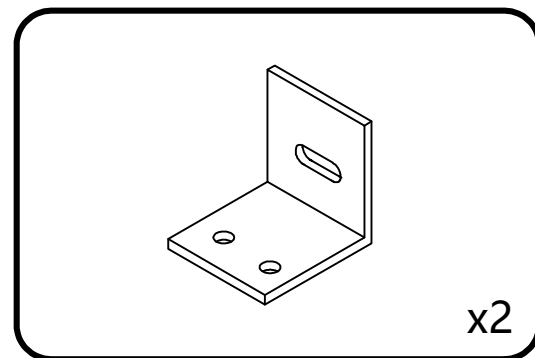

x2

101002

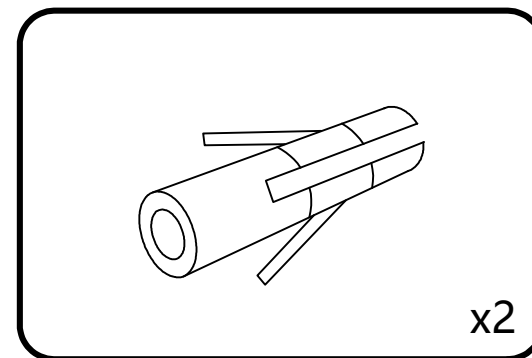

x2

101003

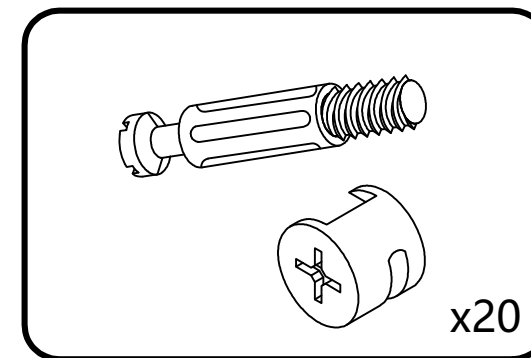

x20

101004

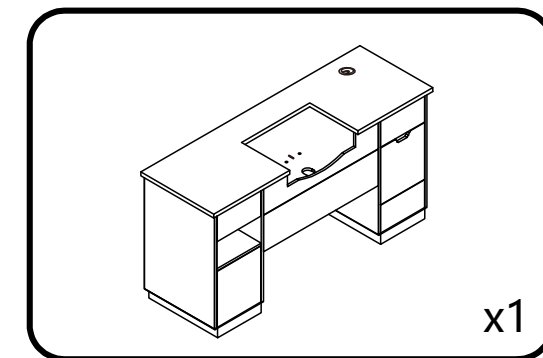

x1

101005

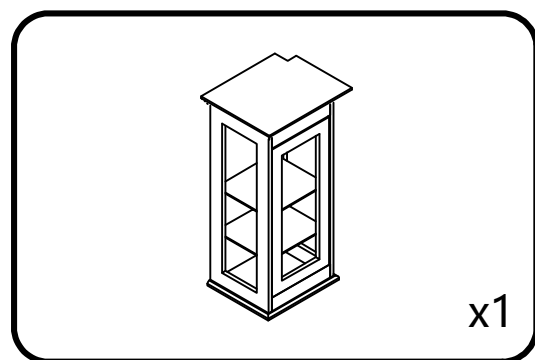

x1

101006

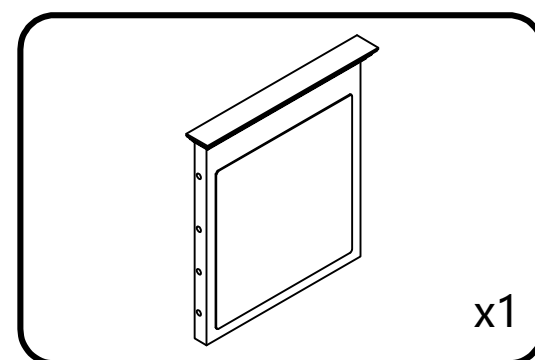

x1

101007

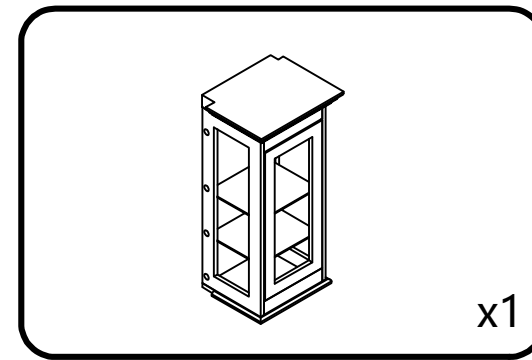

x1

101008

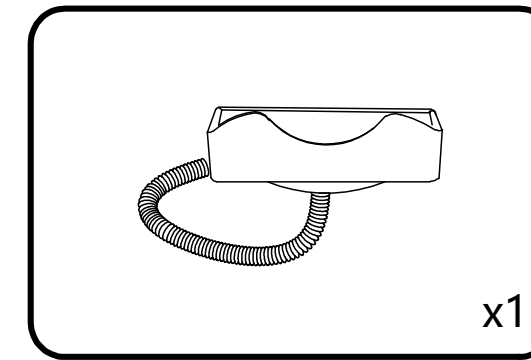

x1

101009

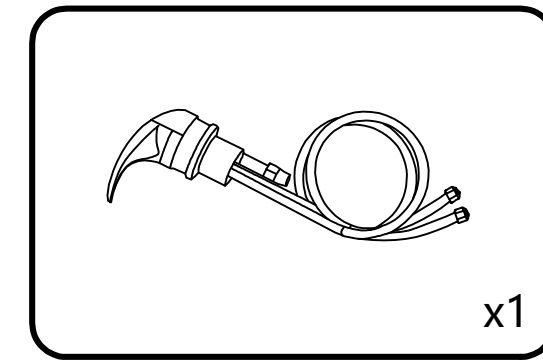

x1

101010

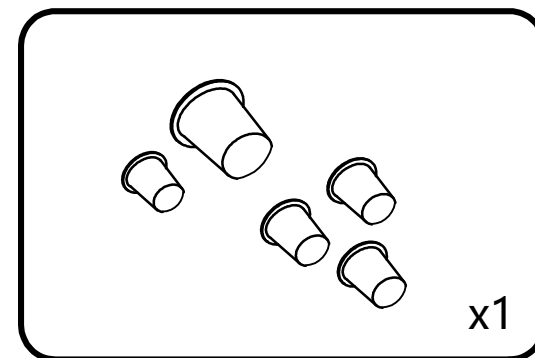

x1

101011

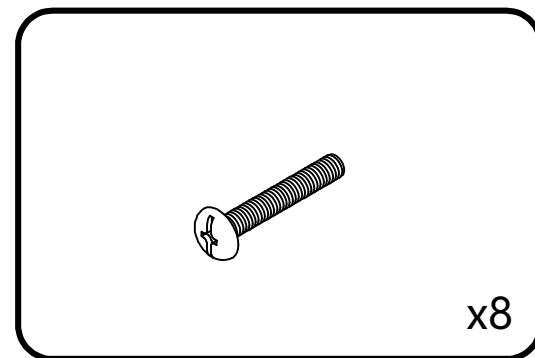

x8

101012

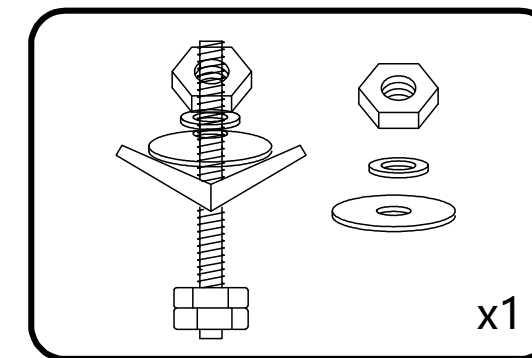

x1

101013

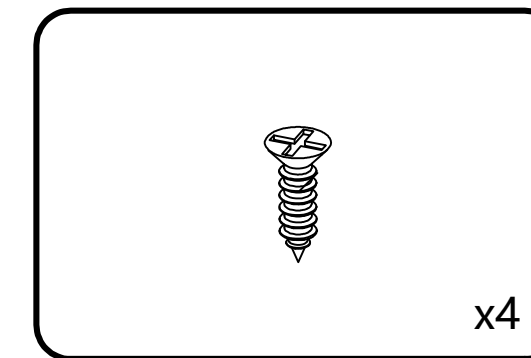

x4

101014

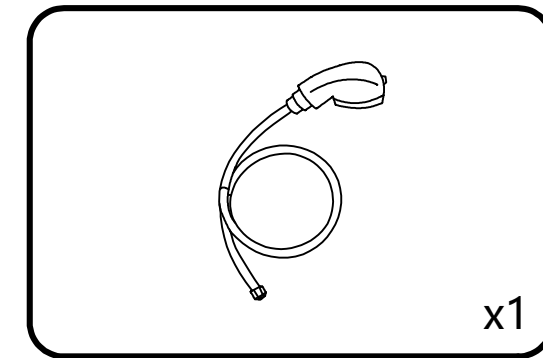

x1

101015

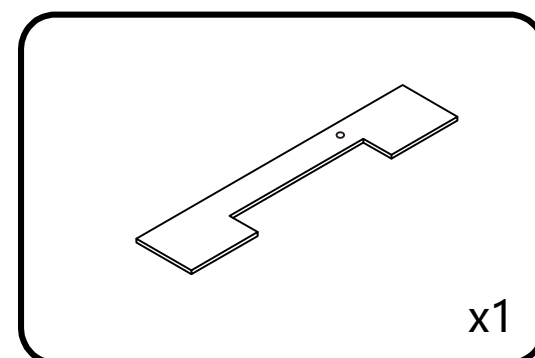

x1

101016

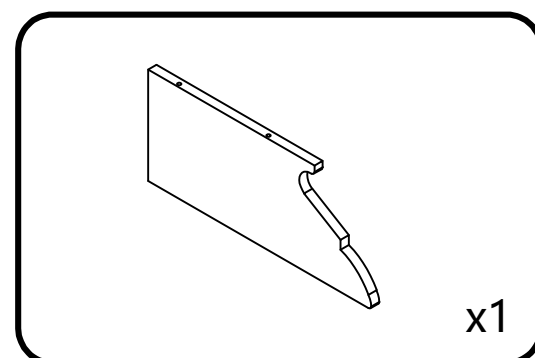

x1

101017

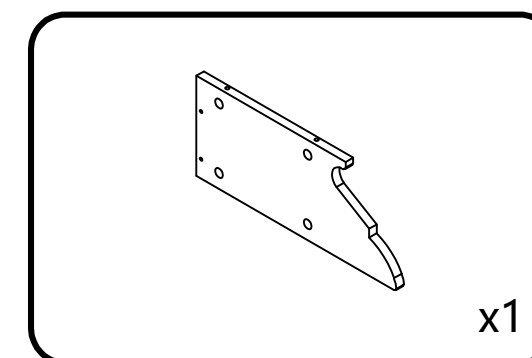

x1

101018

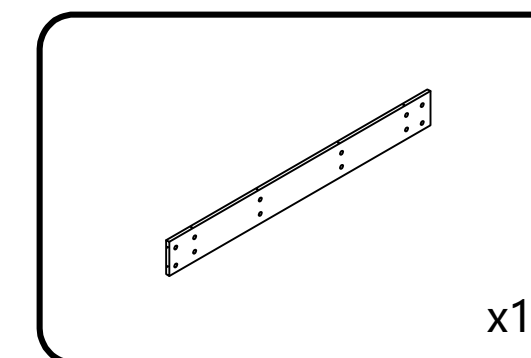

x1

101019

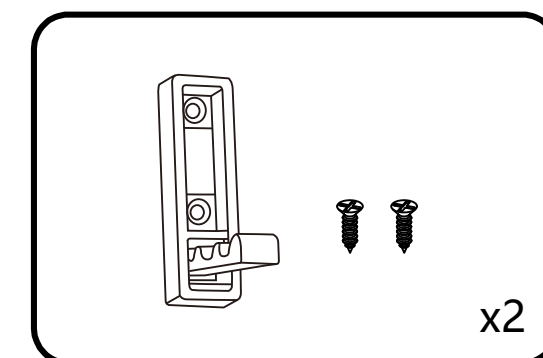

x2

101020

Step 1

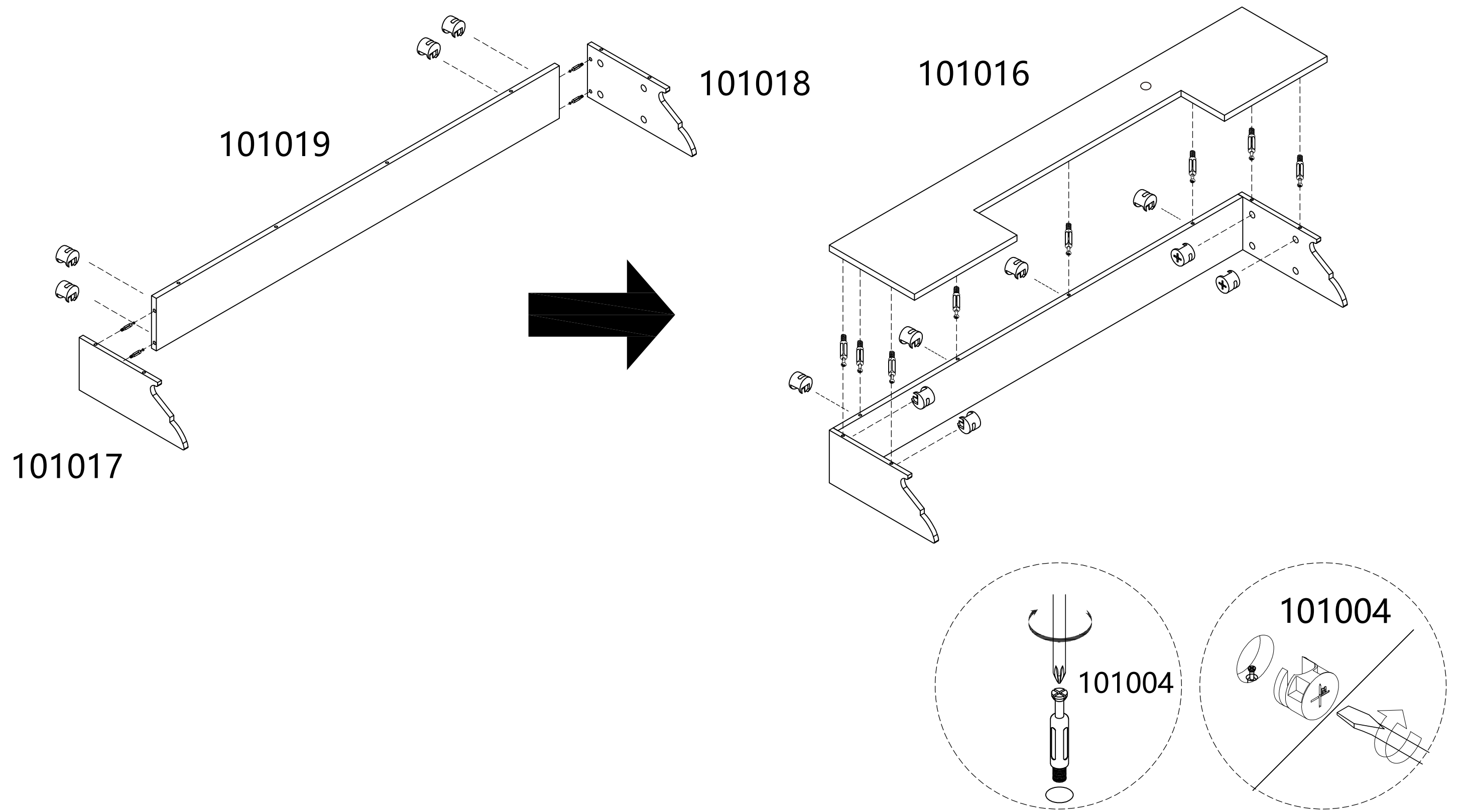

Step 2

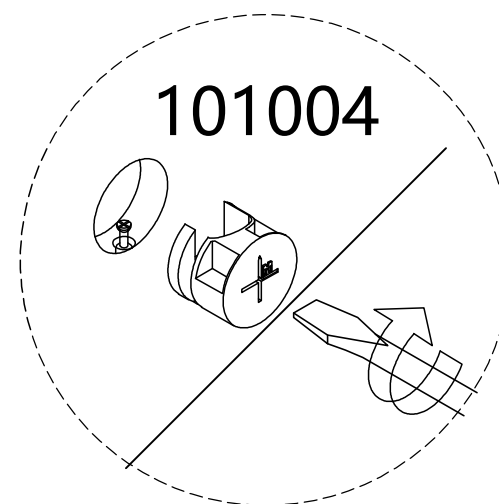
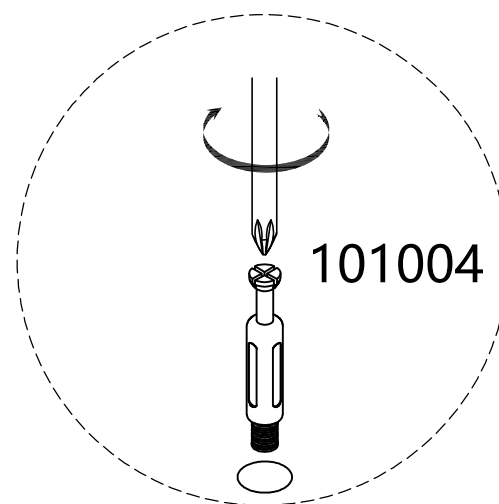
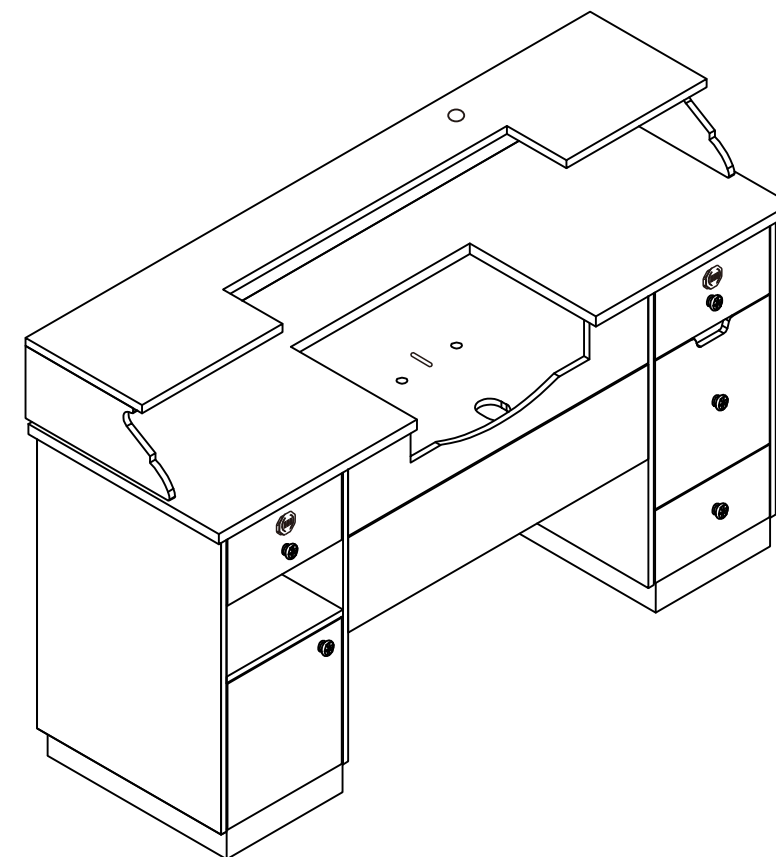
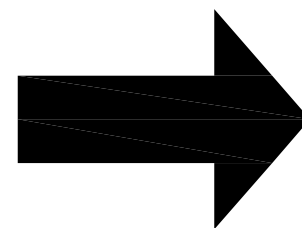
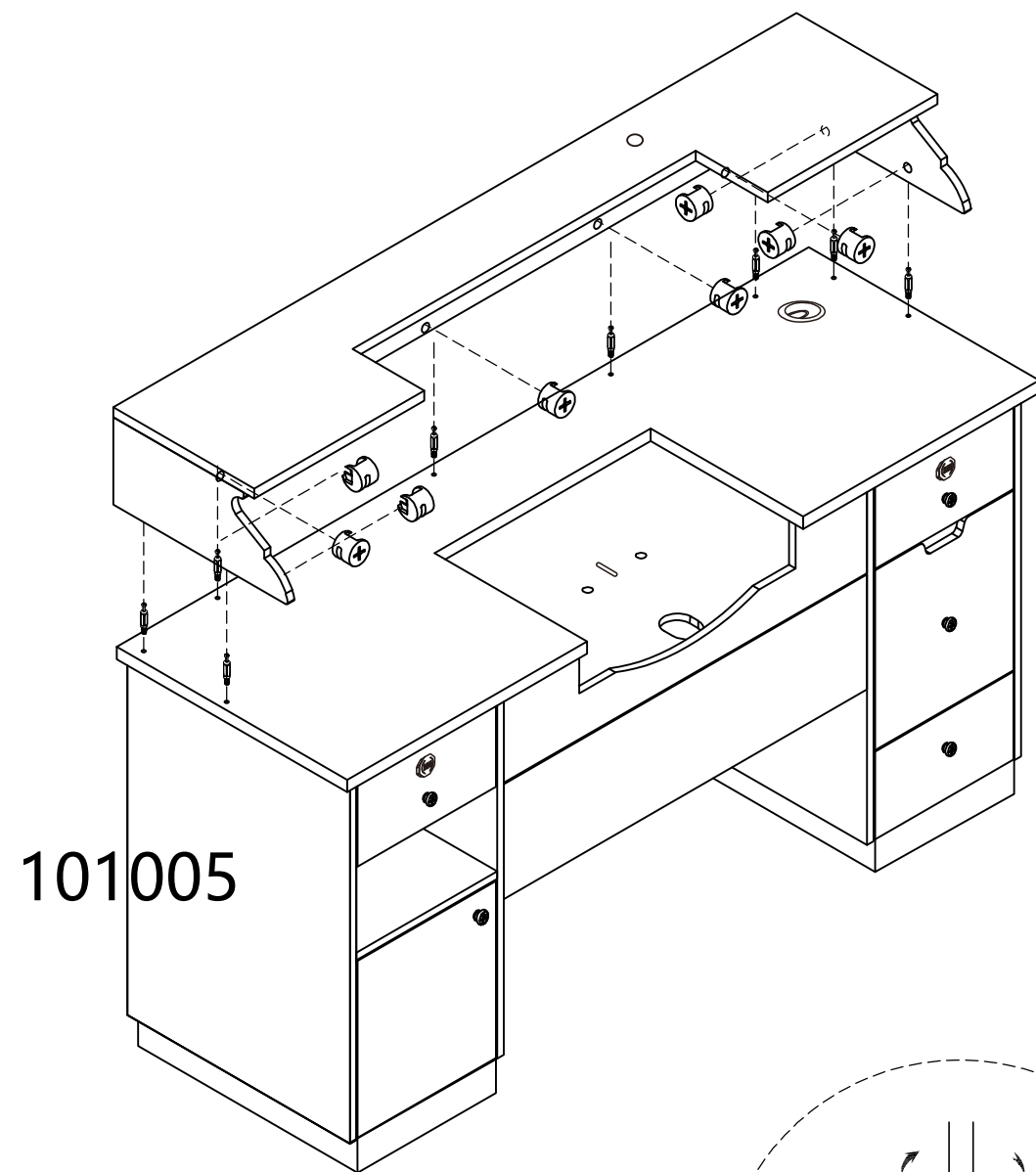

Step 3

The connectors of the black wires are connected to each other, and the connectors of the white wires are connected to each other

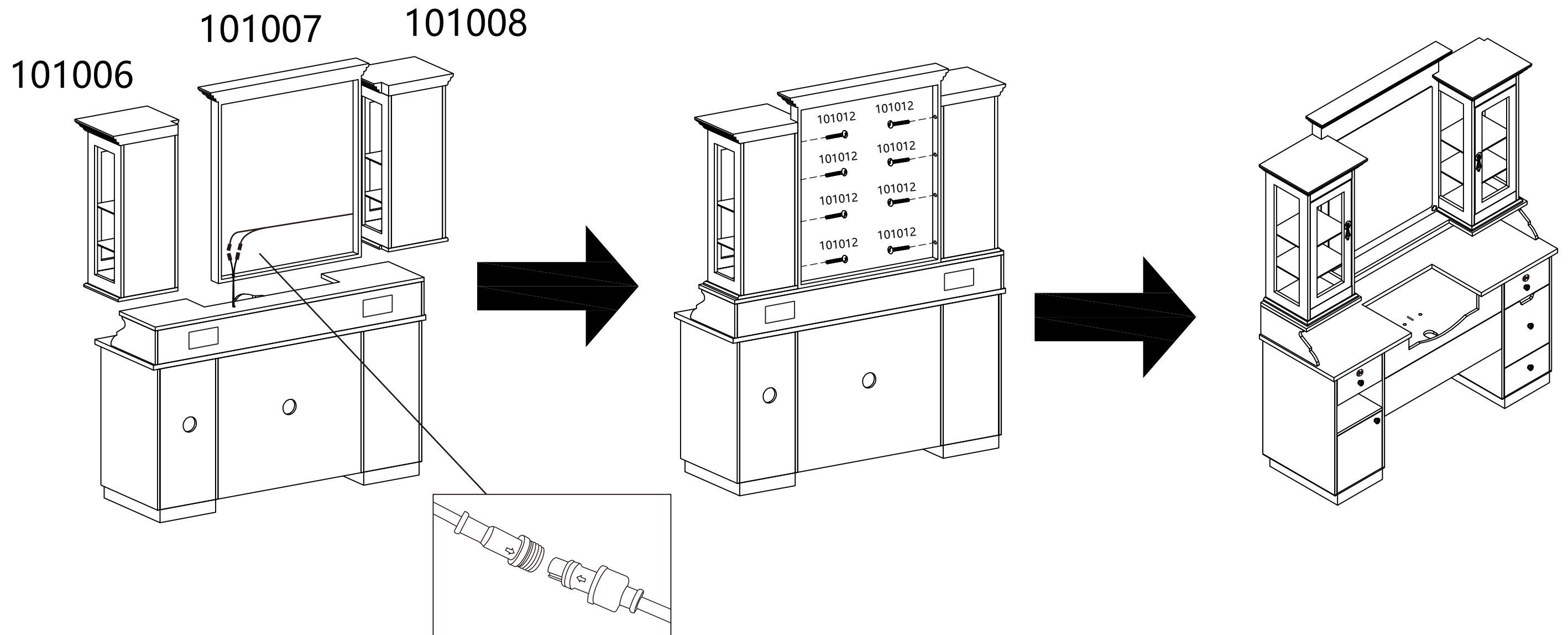

Step 4

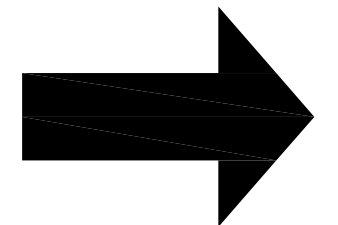
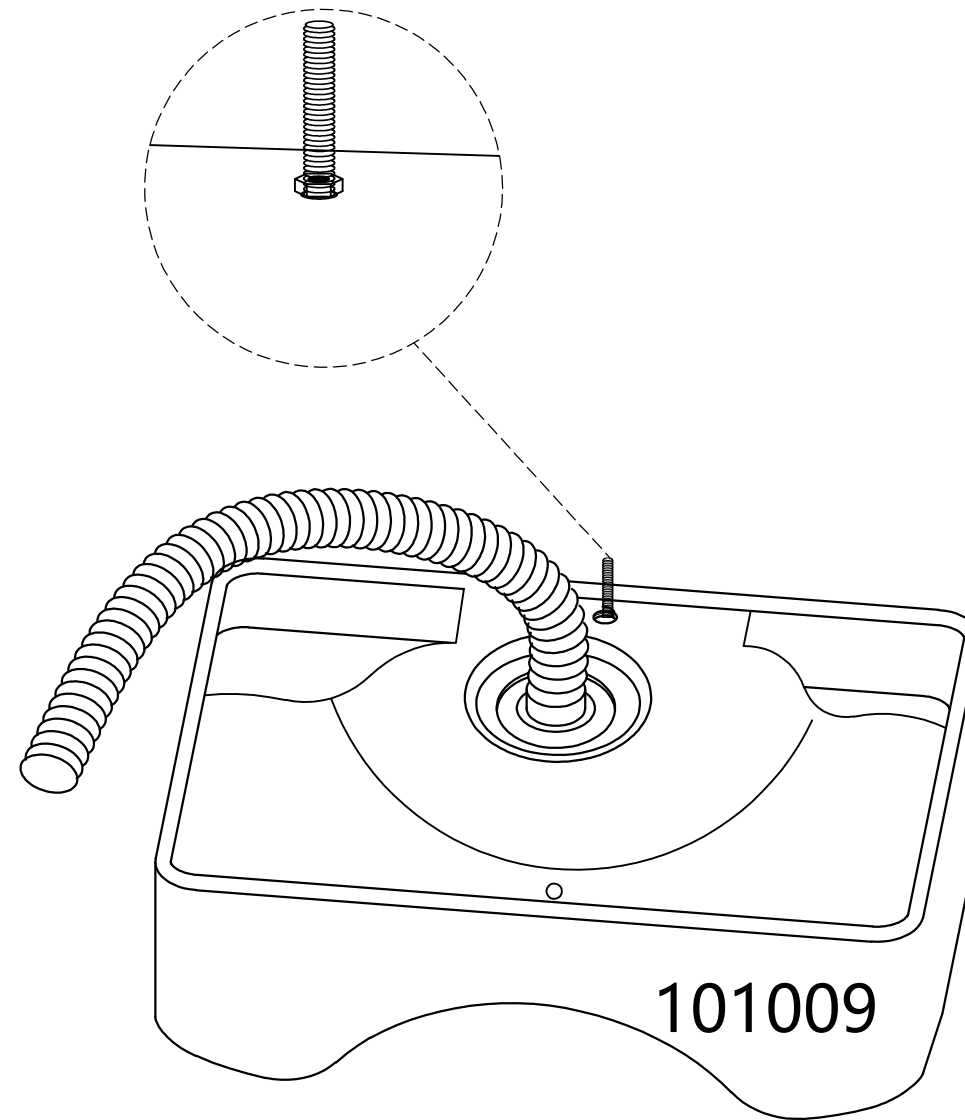
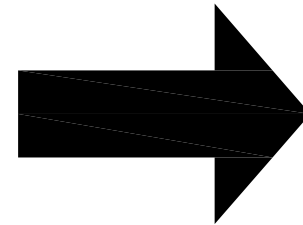
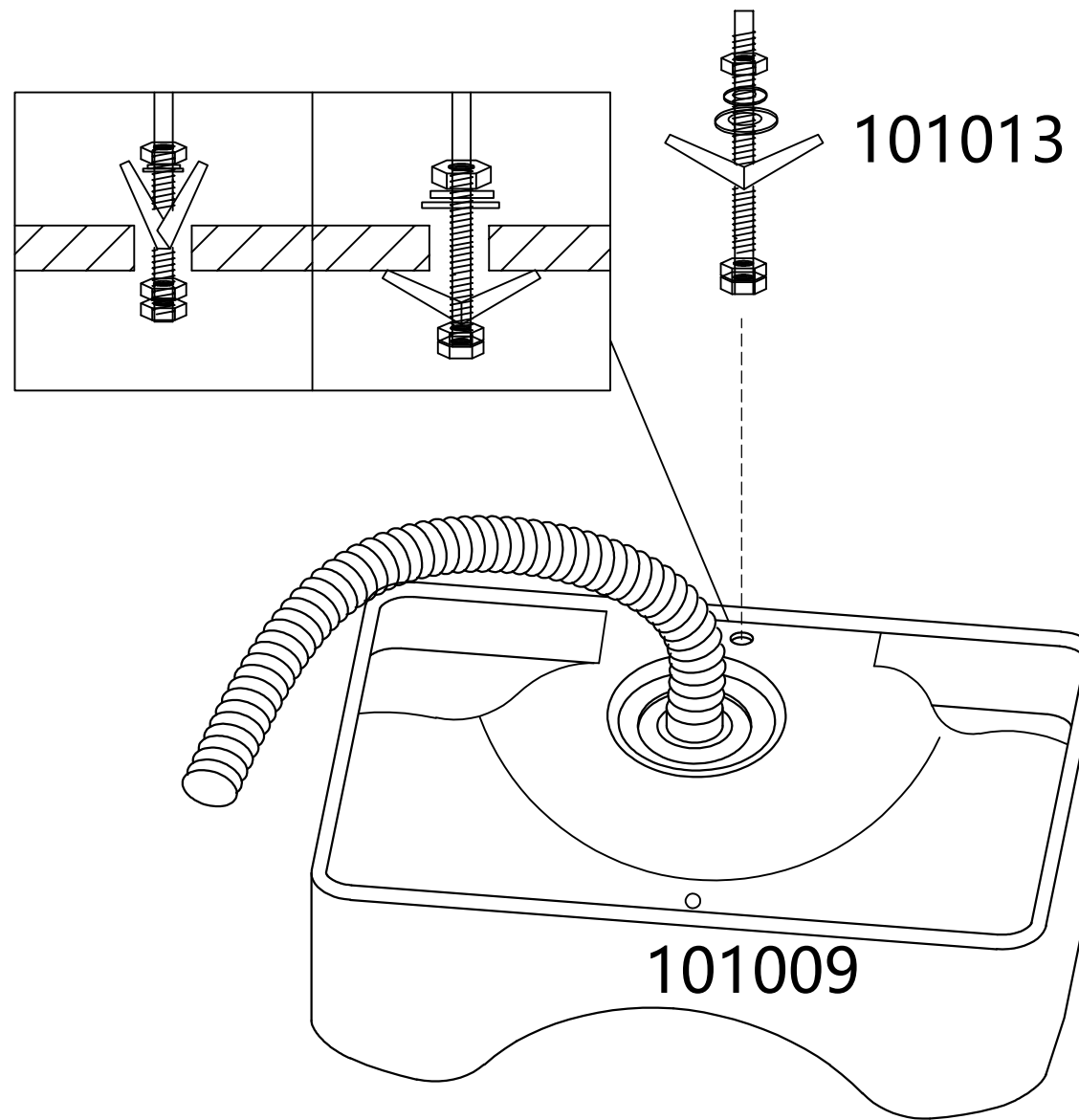

Step 5

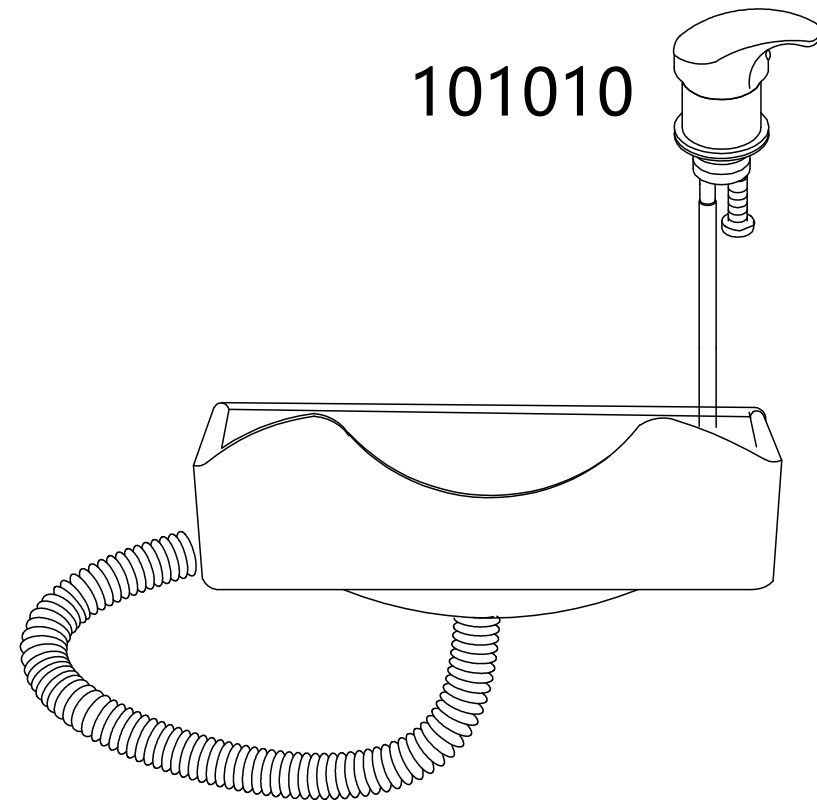

101010

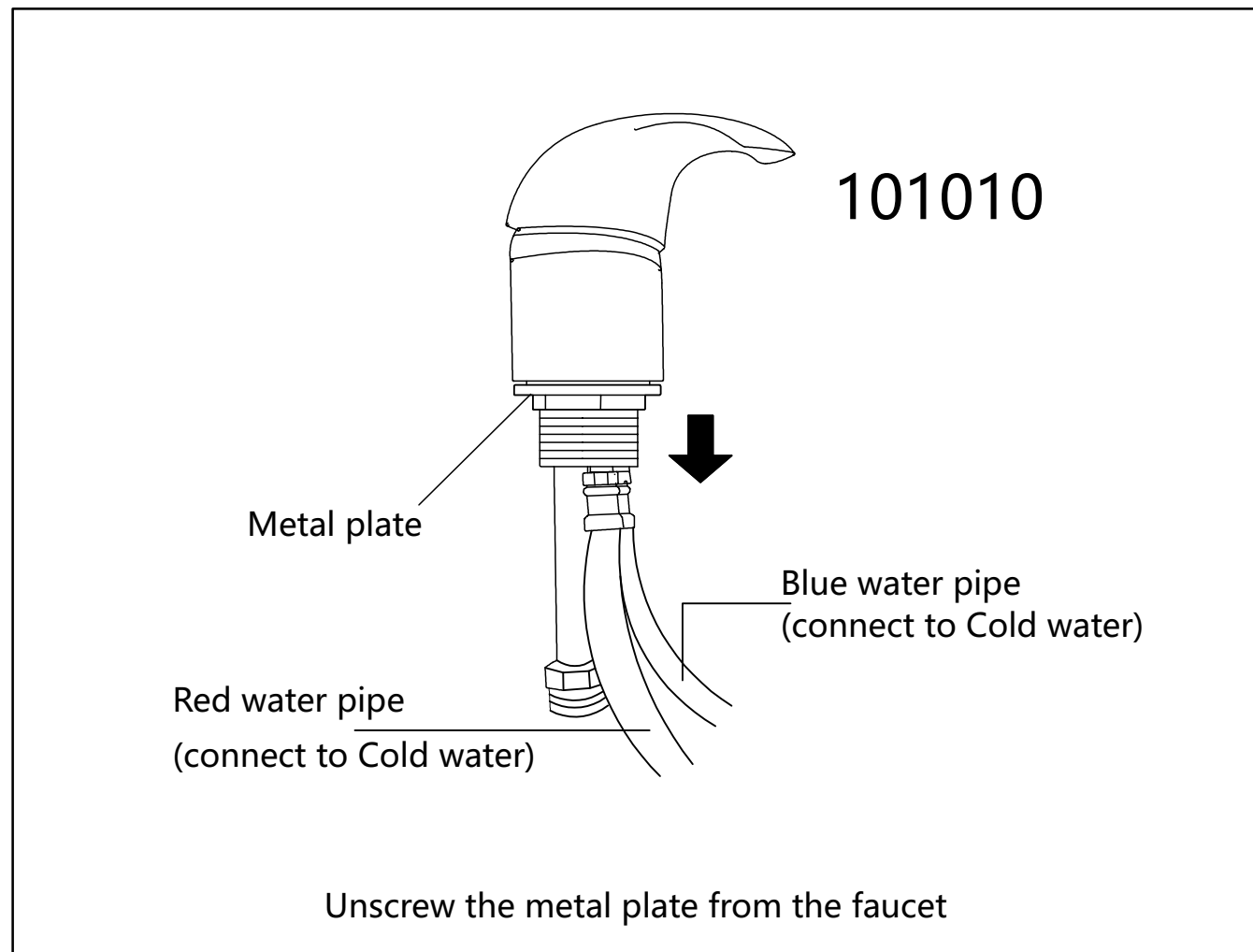

Metal plate

Red water pipe
(connect to Cold water)

Blue water pipe
(connect to Cold water)

Unscrew the metal plate from the faucet

STEP1

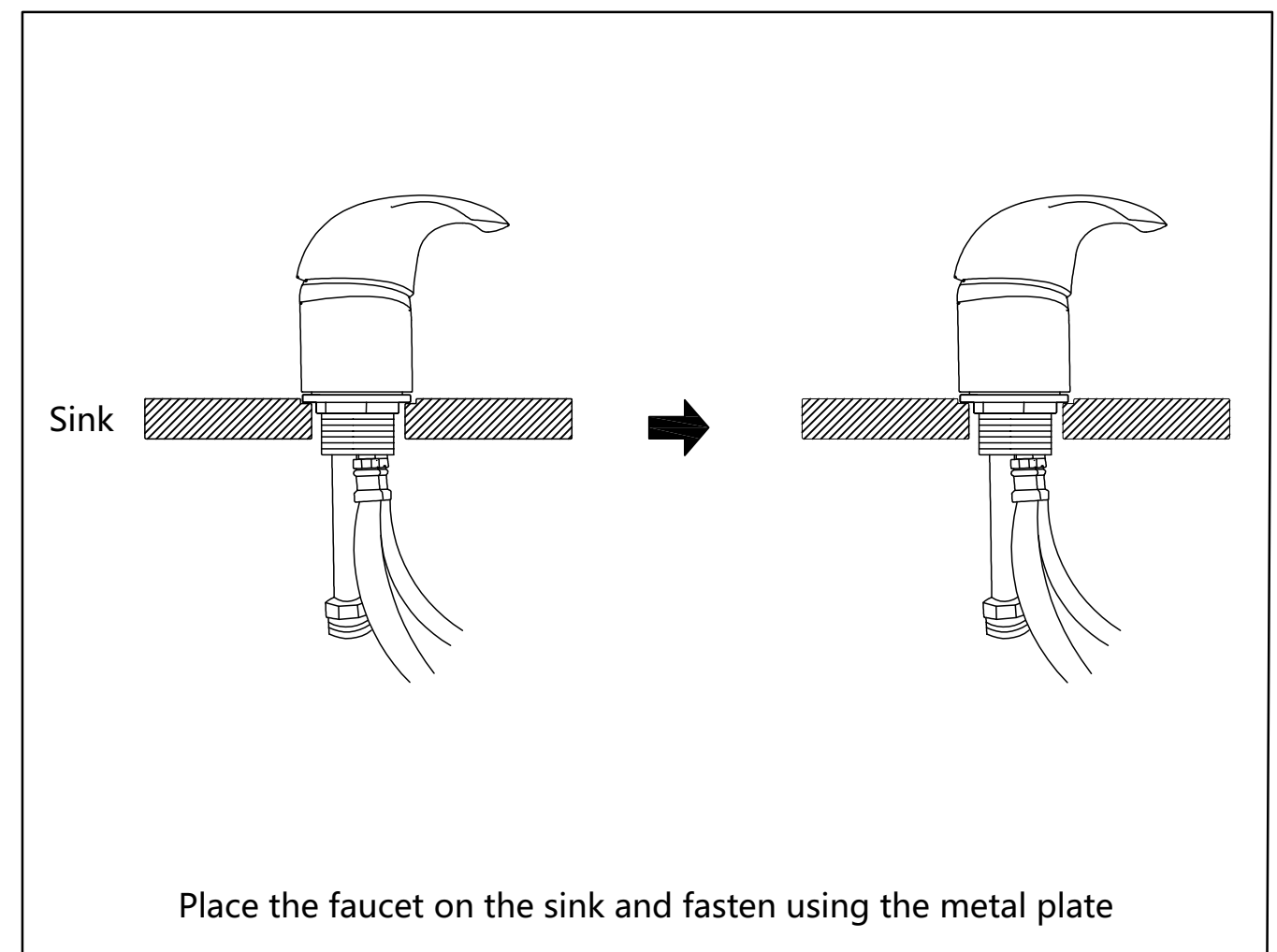

Sink

Place the faucet on the sink and fasten using the metal plate

STEP2

Step 6

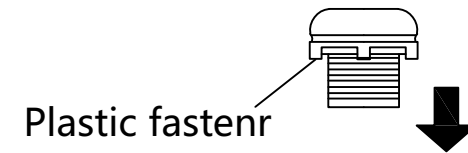
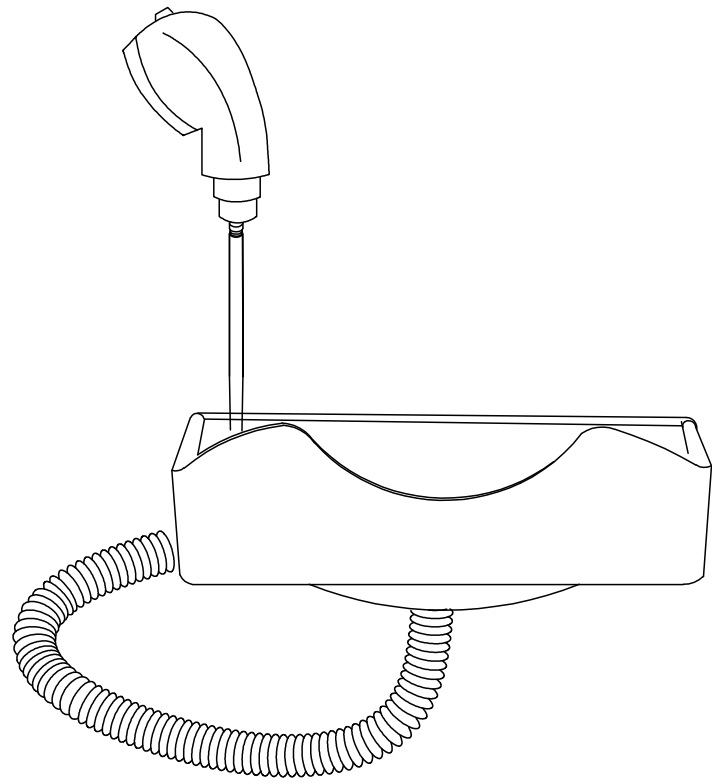

Plastic fastener

Unscrew the fastener from the sprayerhead holder.

STEP1

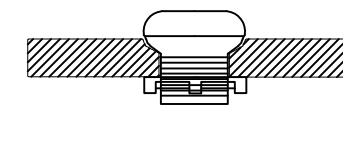
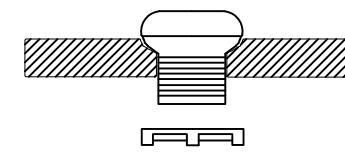

Fasten the sprayerhead holder to the sink with the plastic fastener.

STEP2

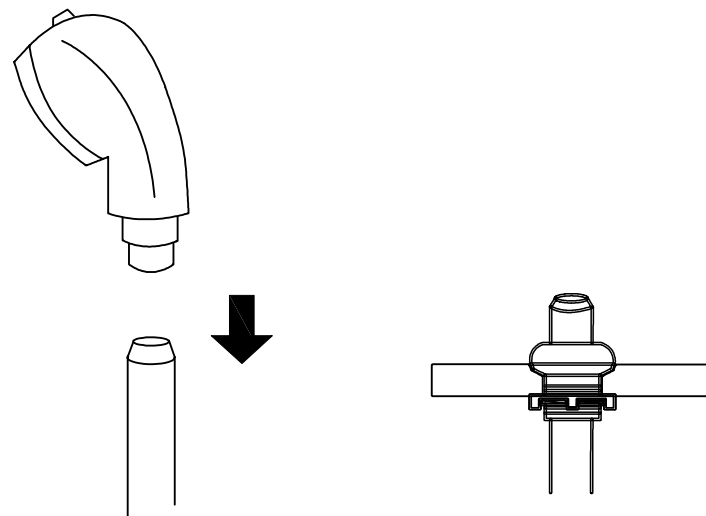

Unscrew the sprayerhead from the sprayer hose.

STEP3

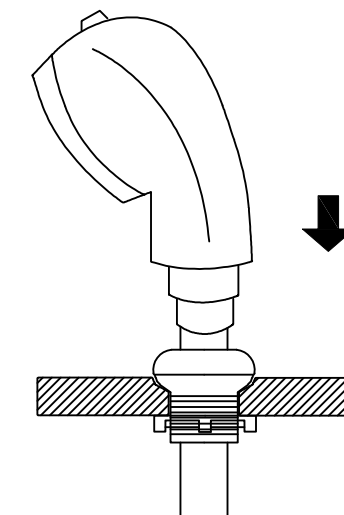
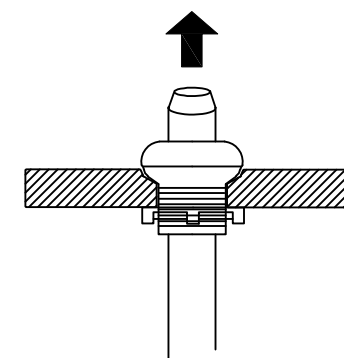

Place the sprayer hose from underneath through the sprayerhead holder and fasten the sprayerhead to the sprayer hose.

STEP4

Step 7

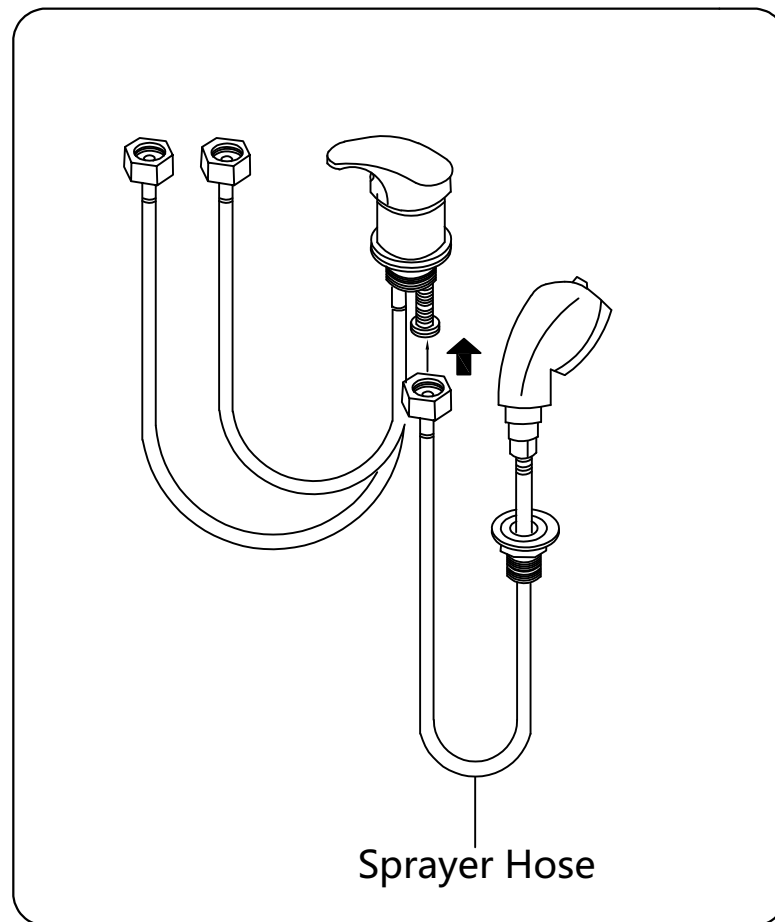

Connect to sprayer hose to the tap shown in the diagram.

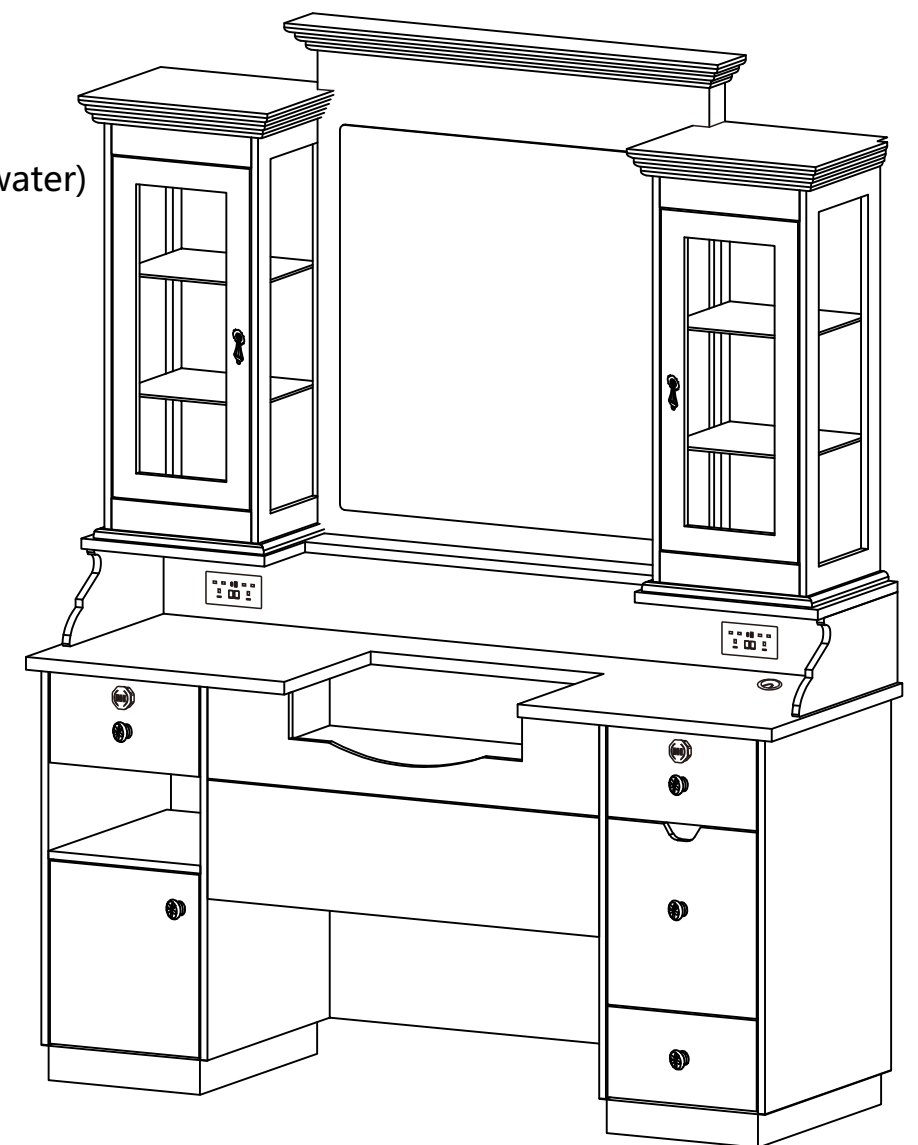
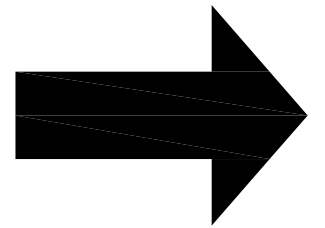
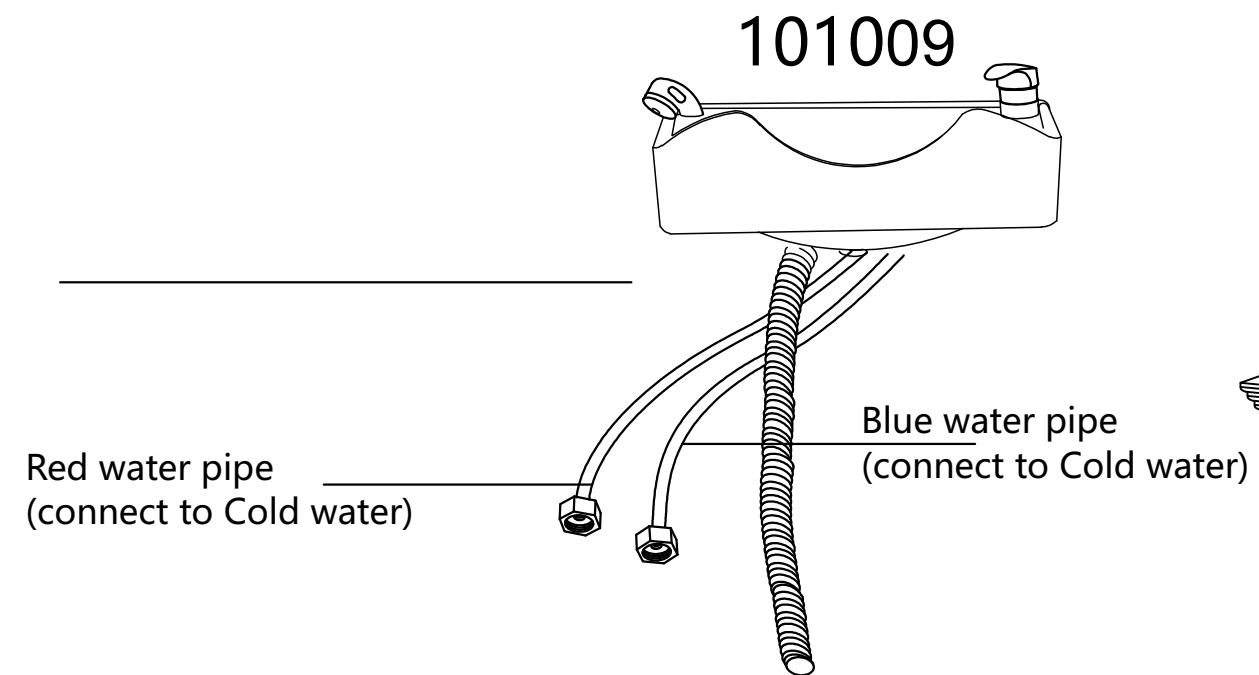

Step 8

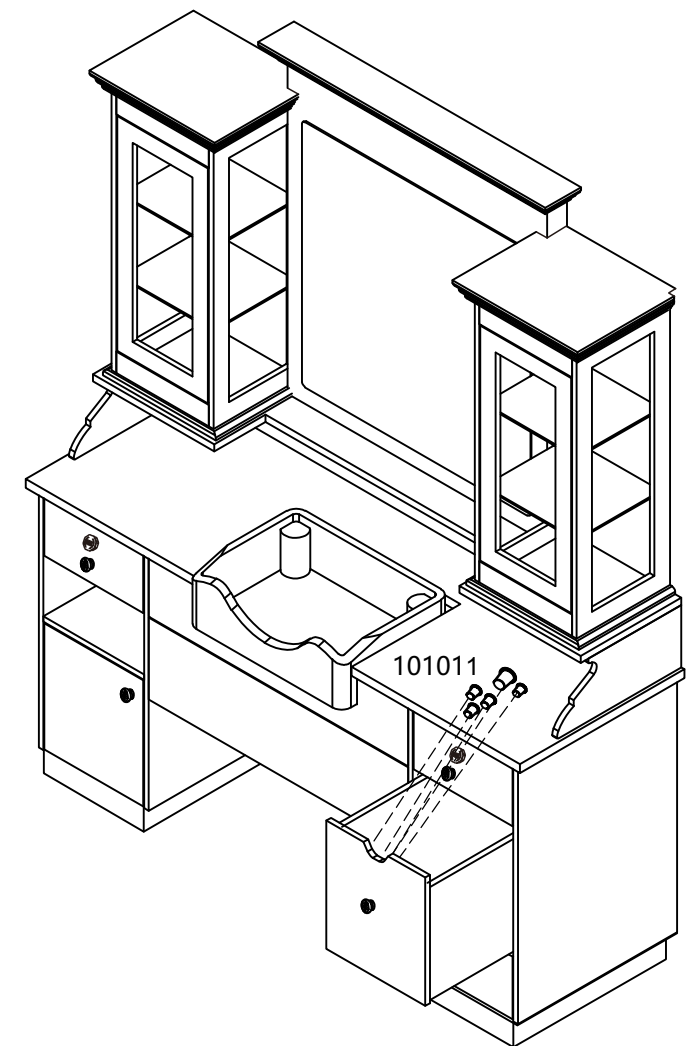
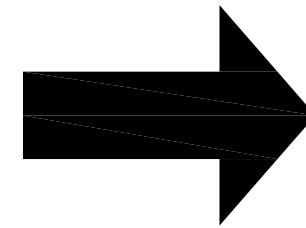
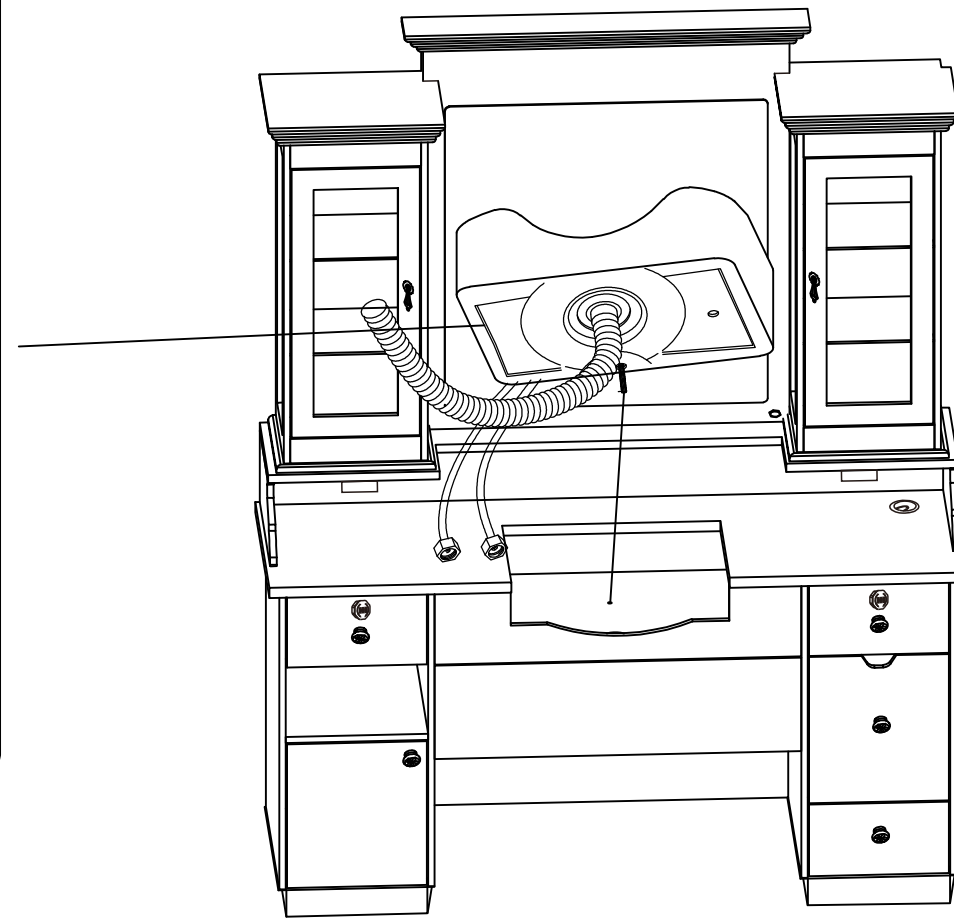
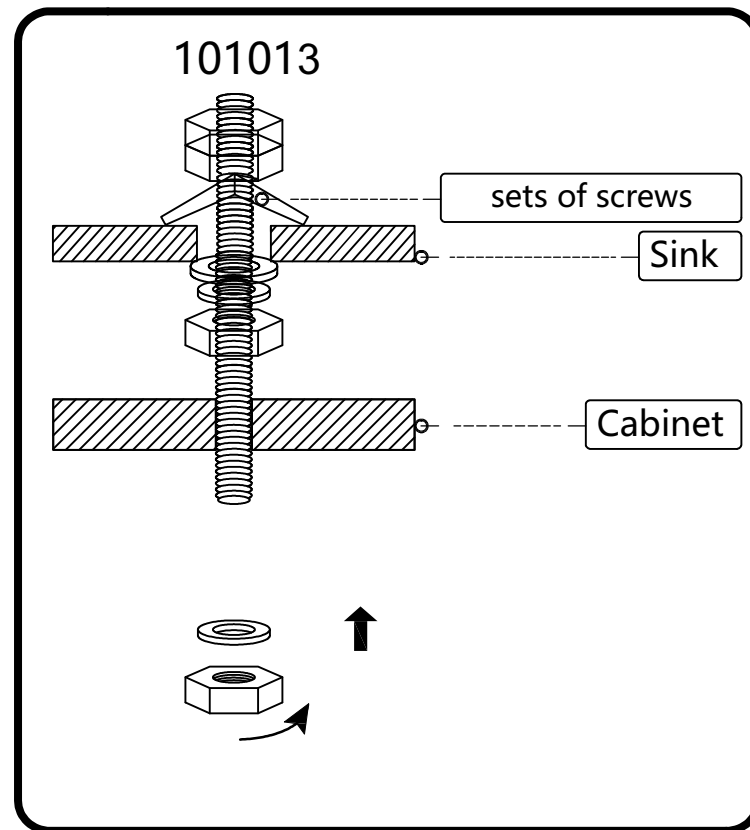

Step 9

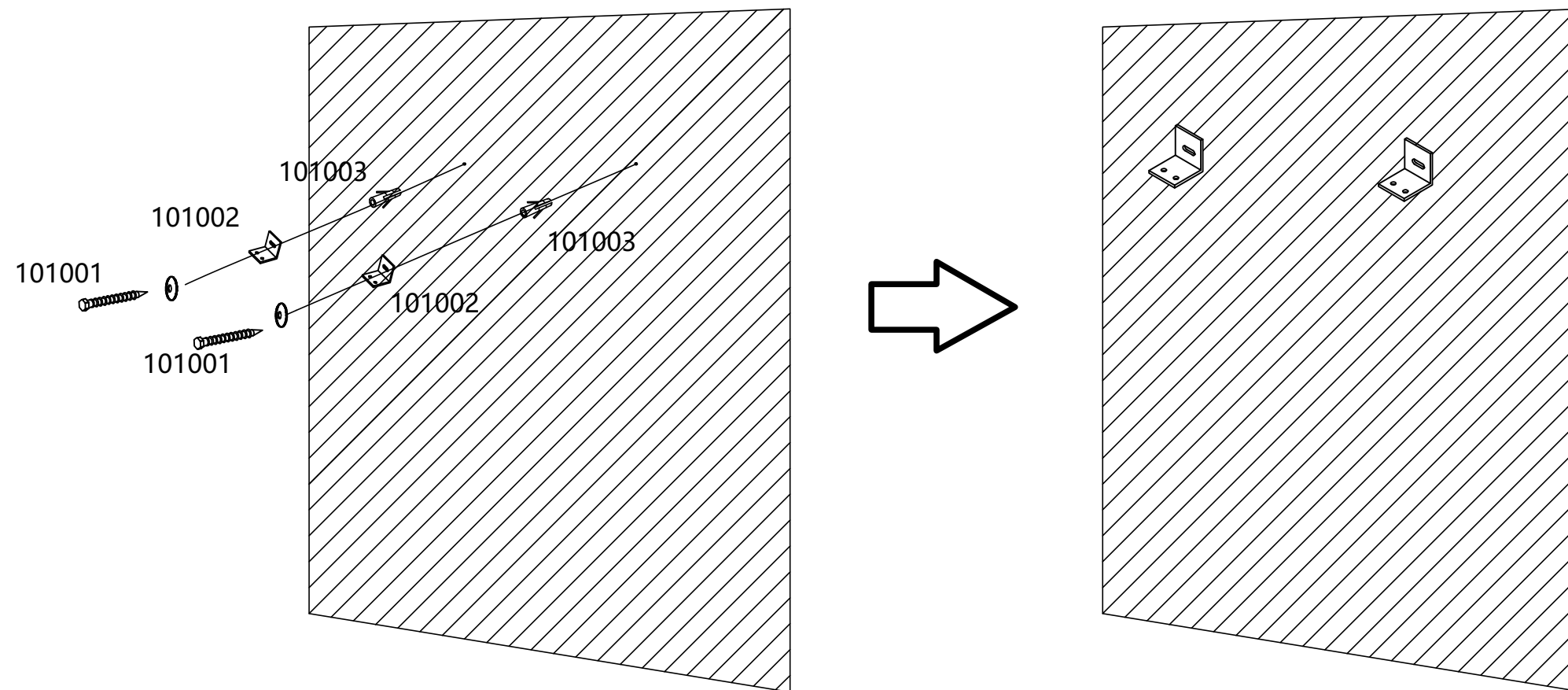

Step 10

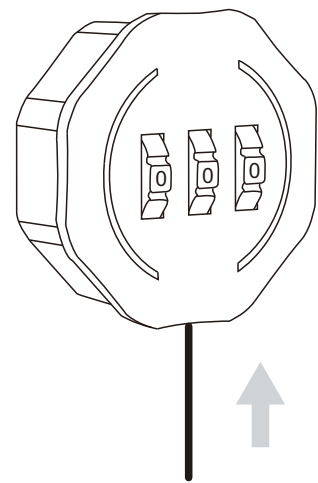
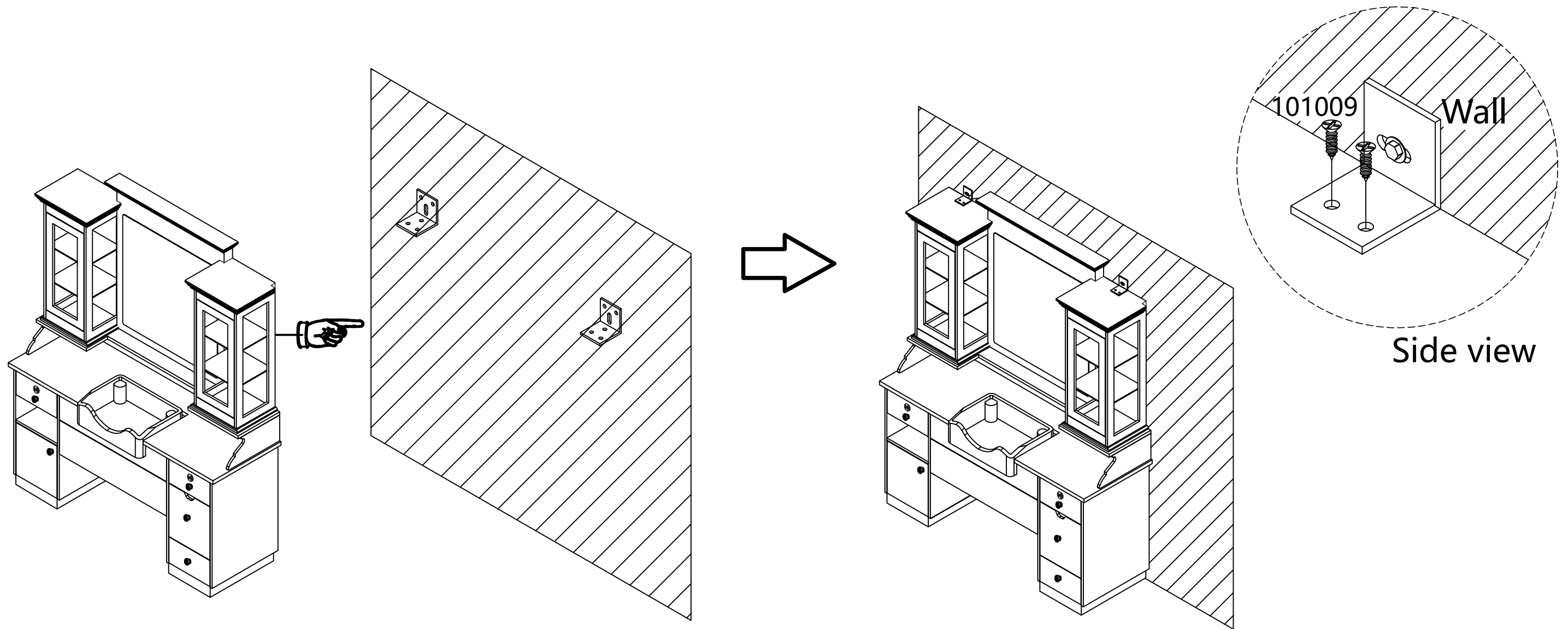

How to change code:

- 1, The default factory code is 000
- 2, Pin the hole on the bottom of the locker
- 3, Change the numbers to your own code and remove the pin to complete

PS: When installing, ensure the inner hole is at the bottom. If there's no spring back sensation when inserting the needle into the password hole, try turning the lock direction and then attempt again.

Step 11

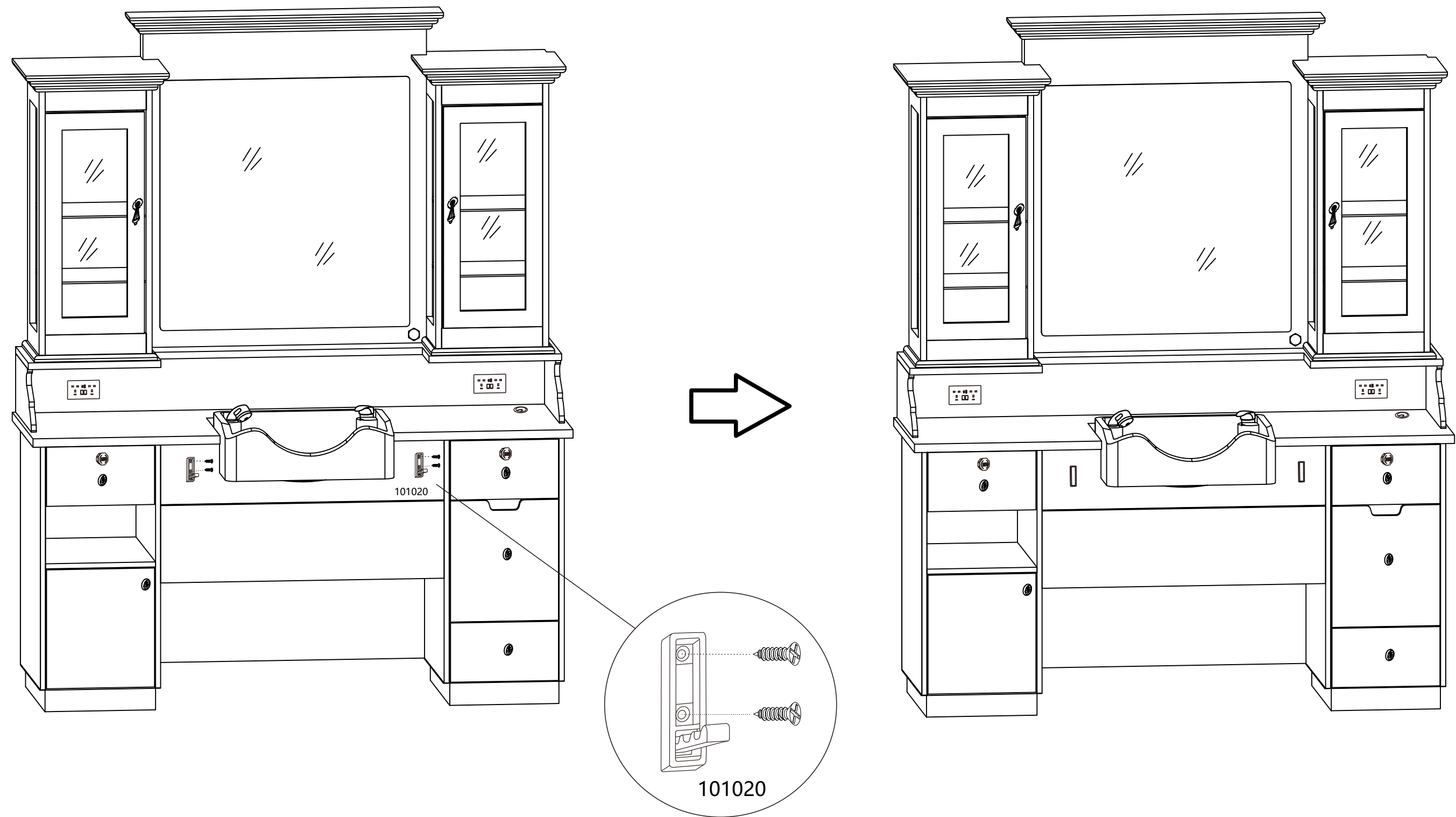

Product care



Brush away excess hair

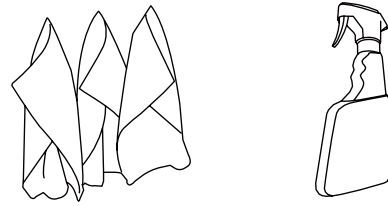

Clean surface with damp cloth or use simple soap & water solution.

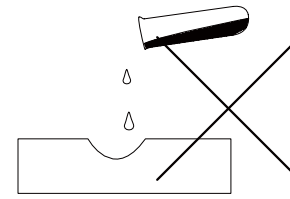

Avoid using corrosive cleaning agents such as bleaches.

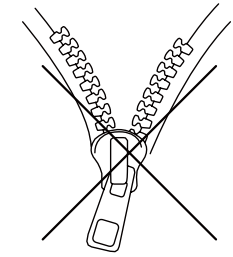

Do not remove upholstery for cleaning

Warranty

The warranty period is one year. DIR warrants to you, the original buyer, that goods shall be free of defects in material and/or workmanship attributable to manufacture for one year from date of receipt of product. Damage resulting from improper handling after merchandise is received, or from exposure to weather or extreme atmospheric conditions is not covered by the warranty. For any other information please contact our support team:

DIR Birmingham

66 Rea Street South
Birmingham
B5 6LB

Email: sales@dirstore.co.uk
Phone: +44 (0) 121 6434777

DIR London

Unit 1 River Road Business Park,
33 River Road, Barking,
Greater London, 1G11 0DA

Email: sales@dirstore.co.uk
Phone: +44 (0) 20 8591 9310

DIR New York

575 Underhill Blvd Suite #170
Syosset, NY 11791, USA

Email: sales@dirsalonfurniture.com
Phone: +1 (718) 628 6668
+1 (800) 728 2008
Fax: +1 (855) 628 5168